

VERTICAL SUBSTRATE STORAGE RACK ASSEMBLY INSTRUCTIONS

PARTS LIST:

- | | |
|----------------------------|---------------------------|
| 25 - Elevator Bolts | 25 - 1/4" x 20 Acorn Nuts |
| 25 - 1/4" x 20 Flange Nuts | 40 - 5/16" x 2" Bolts |
| 20 - Plastic End Caps | 1 - 12' Double Sided Tape |

1. Study assembled and exploded pictures of the rack. We recommend that two people assist in assembly of this rack. The 1st and 2nd panels have no holes. The 3rd panel has holes every 26" on center, starting at center of bottom bar. The 4th panel has holes spaced 20" and 26". The 5th panel only has holes every 20".
2. Stand one panel on its side and attach a 38.5" rail to the bottom as pictured in the illustration or it will be very difficult to tighten the nuts. NOTE the bottom of the panel has a 2" leg and the top has a 1" leg. The bolt goes through the panel first and then through the 38.5" rail. Secure with flange nut and acorn. Snug, but do not tighten until all five panel sections have been secured to all three bottom 38.5" rails.
3. Attach two more 38.5" rails to the bottom of the five panels. Now tighten all (15) hardware assemblies. NOTE that the square part of the bolt will be wedged into the round hole of the tubing and this will allow the nut to be tightened even though there is no bolt head to grip.
4. Stand the assembly up and attach the last two 38.5" rails to the top of the panels. Insert the bolts from below, through the top rail. Secure with a flange nut and acorn nut. Snug, but do not tighten until all (10) hardware assemblies are installed and then tighten as in step 2.
5. Apply the double-sided tape to the center of the opening in each panel by cutting (20) strips at 7" long, each. The tape is applied where the pans sit in the panels. Don't put the tape on any of the bolt heads. Offset the tape in these openings. Be sure to remove tape backing before installing pans. NOTE two people are required to install the pans. Feed the pans in at an angle between panel's vertical rails. When even at both ends, rotate into place and press down to stick to tape.
6. Now you are ready to place the rack in your desired location for use.

You can install the adjustable cross bars to use the four extra pans in the back two slots (see photo below).

NOTE: Rack must be firmly attached to the floor using the tabs at the bottom of the 1st and 5th panel.

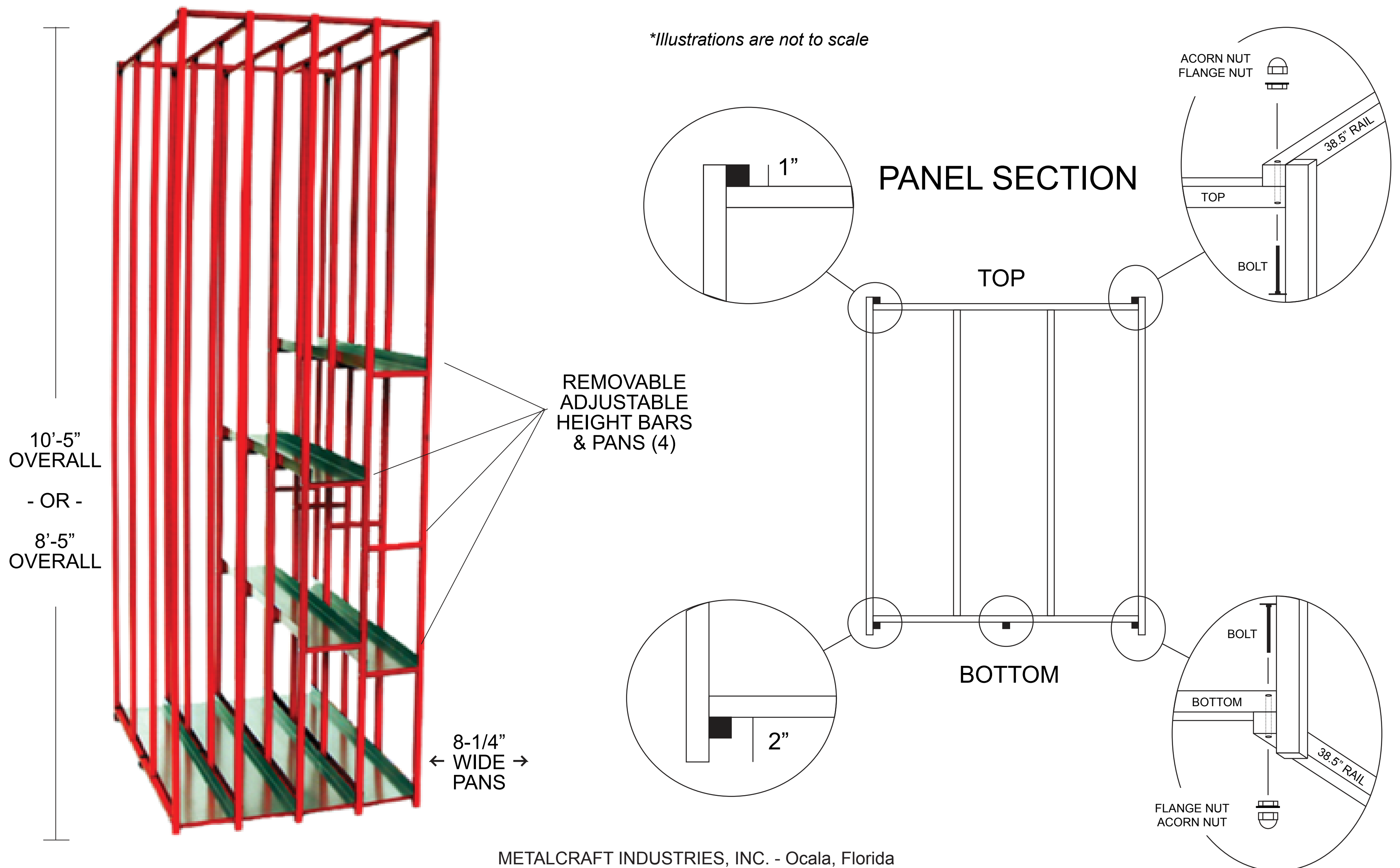

METALCRAFT INDUSTRIES, INC. - Ocala, Florida
 WWW.METALCRAFTINDUSTRIES.NET

ALL PRODUCTS ARE WARRANTED AGAINST MANUFACTURING DEFECTS ONLY